



1200 Aluminum Series

Thermal-Control Sliding Patio Door



Long-lasting, reliable operation, high security

Narrow sight lines maximize view

Slim frames complement modern architectural styles

Durable factory-applied color options

Easy to install pre-fabricated knockdown kits

EFFICIENCY. QUALITY. HIGH VALUE.

1200 Aluminum Series



The **Sunview Aluminum 1200 Series**, the most advanced and flexible aluminum patio door in today's demanding market, is perfect for architectural applications, since its customization options are extensive. Whether it's colour, sill finishes, glass or hardware, the 1200 Series offers the flexibility to comply with virtually any building requirement.

Design Flexibility

In the same perimeter frame, doors can be configured up to six panels wide with fixed or operable panels and coupling members that join larger doors together. They also fill openings or create continuous glass façades. Transoms and fixed sidelites also complete the advanced design.

Draft Protection

To reduce air flow through doors, full perimeter double-fin seal weather stripping creates comfortable, draft-free living spaces.

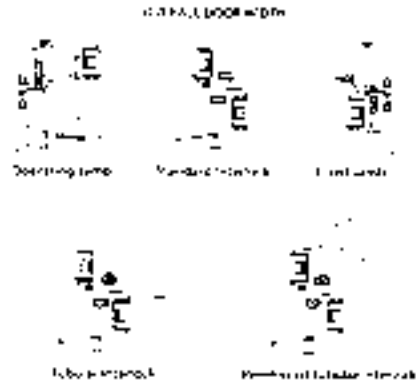

Insulating Glass

One-inch clear tempered sealed insulating glass, or upgrades to argon-filled Low-E coated glass for greater energy performance and cold climate condensation resistance. Colour tinted or reflective glass meets the most demanding architectural specifications.

Super Spacer®

Stays cool in summer



Stays warm in winter

Hardware

Fully adjustable lock set handles satisfy most aesthetic tastes and budgets.

Optional security bars and key locks provide added protection.

Guardian locks provide security while leaving doors open for ventilation.



Features and Options

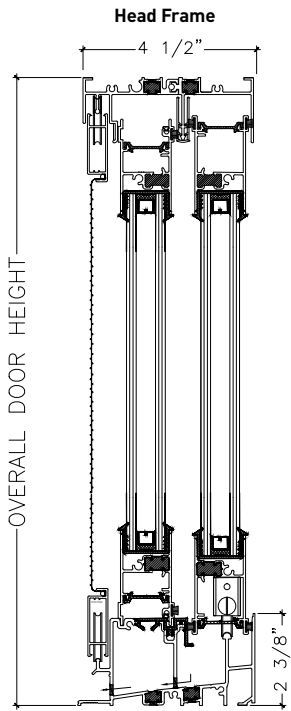

Rain Protection

Varying sill heights in mild to severe climates prevent water penetration.

Architectural Finishes

Electrostatically baked enamel in white or dark bronze - and customized enamel, fluorocarbon, anodized and high-performance finishes.

Dual Split Finish Option

Sunview's innovative design permits different finishes at nominal costs on door insides and outsides - an advantage to owners and architects alike.

Sill Finish Options

Painted or anodized sills with stainless steel tracks, a custom feature, or standard mill finished aluminum.

Transoms and Sidelites

Joining fixed glazing mates with sliding door systems allow greater flexibility for aesthetics and architectural applications.

Easy to Install

For trouble-free installation, frames and panels, are shipped in pre-fabricated knockdown kits, and contain hardware and instructions.

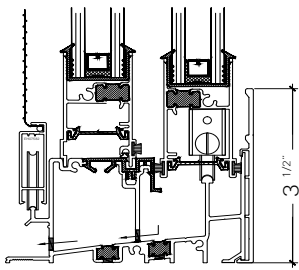

Easy Operation

Rolling quietly and smoothly on adjustable tandem steel ball bearing rollers, independently adjustable door panels achieve ease-of-operation while protecting against the elements. For coastal climates, order stainless steel rollers.



Optional Exterior Colours

Sunview's patio doors boast a wide range of exterior colour options that feature a durable finish that is also UV stable.





1200 Series

Thermal-Control Sliding Patio Door

Dimensions Door/Panel Configurations and Finished Sizes (Exterior view)

2 Panels		3 Panels		4 Panels	
OX-Slide Left	XO-Slide Right	OXO-Slide R to L or OZO-Slide L to R	XOO-Slide R or OOX Slide L	OXXO-Slide R and Slide L from Centre	
Product Code	Frame Size	Product Code	Frame Size	Product Code	Frame Size
5068	59 x 79¹/₂	7668	88⁷/₈ x 79¹/₂	7668	89¹/₄ x 79¹/₂
6068	71 x 79¹/₂	9068	106⁷/₈ x 79¹/₂	9068	107¹/₄ x 79¹/₂
8068	95 x 79¹/₂	12068	142⁷/₈ x 79¹/₂	12068	143¹/₄ x 79¹/₂
				10068	118¹/₄ x 79¹/₂
				12068	142¹/₄ x 79¹/₂
				16068	190¹/₄ x 79¹/₂

Performance

	Configuration	Test Standard	Air Leakage Rating	Water Penetration Resistance	Design Pressure	Reinforcement Details
R-PG55 Type SD-Sill 2-3/8"	OX / XO	AAMA/WDMA/CSA 101/I.S.2/A440-11 and CSA A440S1-09	A3 - 0.4 L/s-m ²	440 Pa (9.2 psf)	±2640 Pa (±55 psf)	Standard Interlock
LC-PG50 Type SD-Sill 2-1/4"	OX / XO	AAMA/WDMA/CSA 101/I.S.2/A440-11 and CSA A440S1-09	A2 - 0.6 L/s-m ²	400 Pa (8.3 psf)	±2400 Pa (±50 psf)	Heavy-Duty Interlock
LC-PG55 Type SD-Sill 2-1/4"	OX / XO	AAMA/WDMA/CSA 101/I.S.2/A440-11 and CSA A440S1-09	A2 - 0.6 L/s-m ²	400 Pa (8.3 psf)	±3600 Pa (±75 psf)	Heavy-Duty Interlock J Reinforcement-Lock Stile
LC-PG30 Type SD-Sill 2-3/8"	OX / XO	AAMA/WDMA/CSA 101/I.S.2/A440-11 and CSA A440S1-09	A3 - 0.5 L/s-m ²	440 Pa (9.2 psf)	±1440 Pa (±30 psf)	Heavy-Duty Interlock
LC-PG30 Type SD-Sill 3-1/2"	OX / XO	AAMA/WDMA/CSA 101/I.S.2/A440-11 and CSA A440S1-09	A3 - 0.5 L/s-m ²	720 Pa (15 psf)	±1440 Pa (±30 psf)	Heavy-Duty Interlock
CW-PG50 Type SD-Sill 3-1/2"	OX / XO	AAMA/WDMA/CSA 101/I.S.2/A440-11 and CSA A440S1-09	A2 - 0.6 L/s-m ²	720 Pa (15 psf)	±2400 Pa (±50 psf)	Heavy-Duty Interlock J Reinforcement-Lock Stile P Reinforcement-Interlock
AW-PG50 Type SD-Sill 3-1/2"	OX / XO	AAMA/WDMA/CSA 101/I.S.2/A440-08 and CSA A440S1-09	A2 - 1.4 L/s-m ²	720 Pa (15 psf)	±2400 Pa (±50 psf)	Heavy-Duty Interlock J Reinforcement-Lock Stile P Reinforcement-Interlock
R-PG40 Type SD-Sill 2-3/8"	OXO	AAMA/WDMA/CSA 101/I.S.2/A440-11 and CSA A440S1-09	A3 - 0.4 L/s-m ²	440 Pa (9.2 psf)	±1920 Pa (±40 psf)	Heavy-Duty Interlock

Distributed By:

